



RACKS MATRIX
STORAGE SOLUTIONS

COMPANY PROFILE

**Say Good Bye
To Inventory Aging**





RACKS MATRIX

S T O R A G E S O L U T I O N S

➤ CONTANT

About Us	3
Rack Cladding	5
Radio Shuttle	8
Selective Pallet Rack	12
Drive-In Racking	18
Mobile Pallet Racking	25
Cantilever	28
Mobile Shelving	31
Mezzanine	34
Long Span Shelving	39
Lockers	42
Mobile Yard Ramp	44
Dock leveler	46
Forklifts	48
Goods Elevator	51
Pallets	53
Cages	56
Racks Accessories	57
Our Partners	58
Notes	60

➤ COMPANY OVERVIEW :

Racks Matrix is a company dedicated to optimizing storage and materials handling for businesses. We specialize in providing racking systems, storage solutions, and handling equipment to enhance workspace efficiency.

➤ PRODUCTS & SERVICES :

Racking Systems: Racks Matrix offers a variety of racking systems, designed to help businesses save space and easily access their stored items.

➤ CORE VALUES:

Quality: We prioritize delivering top-quality products and services that stand the test of time.

Innovation: We stay at the forefront of storage and handling trends to offer modern solutions.

Customer-Centric: Our customers' needs are our priority, and we work closely with them to find the right solutions

Sustainability: We are committed to eco-friendly practices and offer environmentally responsible options

Safety: Safety is paramount in all our products and services

➤ CLIENTELE :

Racks Matrix serves a diverse range of businesses, including warehouses, stores, and factories, helping them enhance efficiency and organization

➤ MISSION STATEMENT :

"To empower businesses by providing innovative and tailored racking systems, storage solutions, and handling equipment that enhance efficiency, organization, and safety.

We are committed to delivering exceptional quality and customer-focused service, supporting our clients' growth and success."

"At Racks Matrix, our mission is to simplify storage and handling for businesses, driving efficiency and cost-effectiveness in their operations."

➤ VISION STATEMENT :

"Our vision at Racks Matrix is to be the preferred partner for businesses seeking to optimize storage and handling, contributing to their success and growth."

Our vision is to become the industry leader in racking systems, storage solutions, and handling equipment. We aim to revolutionize the way businesses manage their materials, optimizing space and resources to create more sustainable and productive workspaces.

Through continuous innovation and a relentless focus on customer satisfaction, we aspire to be the trusted partner for businesses worldwide, driving their operational excellence and competitiveness.



Rack Cladding

➤ Rack Cladding

Rack cladding systems are commonly made from materials such as steel, wire mesh, or perforated panels. The choice of material depends on the specific application and the level of visibility and protection required.

These systems are designed to fit precisely around existing storage racks, ensuring a tailored and secure fit. They can be customized to accommodate different rack heights, depths, and configurations.



a rack cladding system serves as a versatile solution to enhance safety, security, and organization in warehouses and storage facilities, making them an essential component of modern industrial logistics.

Space Optimization: Maximizes vertical storage space while maintaining accessibility.

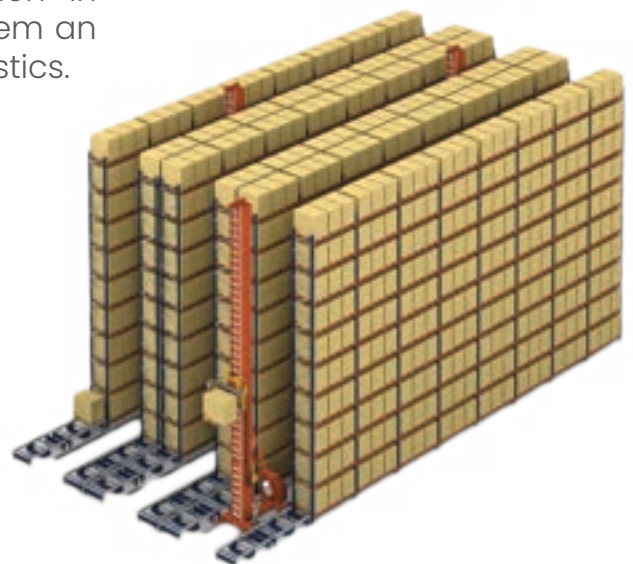



TECHNOLOGICALLY ADVANCED SOLUTIONS

Rack clad building storage solutions are technologically advanced structures, that allow the storage of palletized goods At the height (up to +40 m.), and serve the dual function of storage equipment and building structure, on which cladding and roof are fixed.

The image features a background of a warehouse with tall, industrial shelving units. The shelving is constructed from grey metal beams and orange-colored horizontal supports. The perspective is looking up, creating a sense of height and depth. The lighting is somewhat dim, with a blueish tint. Overlaid on the center of the image is the Radio Shuttle logo, which consists of a stylized white icon of three horizontal bars of varying lengths, followed by the text "Radio Shuttle" in a clean, white, sans-serif font.

 Radio Shuttle

➤ Radio Shuttle

The main feature of our satellite cart system is to streamline the loading and unloading of goods without the need for forklifts to access the storage channels.

The satellite cart circulates by lanes, independently selecting the incoming and outgoing pallets by means of a control tablet, which allows a more efficient warehouse management.

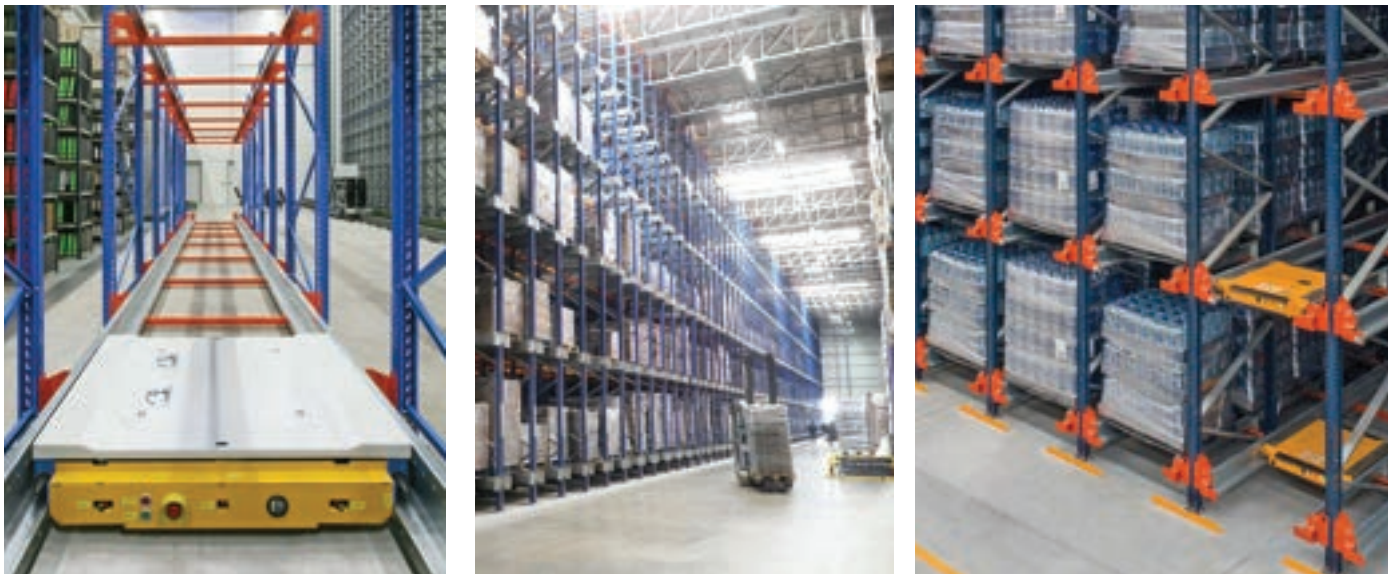

Renovate and convert your old deep storage facility for palletized loads into a new, modern facility automatically managed by the satellite cart.

The main feature of our satellite cart system is to streamline the loading and unloading of goods, without the need for forklifts to access the storage channels.





MAIN ADVANTAGES:

- Accuracy and speed, Reduction of working time compared to a conventional compact system .
- Increased safety. Forklifts do not have to enter the loading lanes, reducing the risk of accidents to people and racks .
- Ease of use and maintenance, reducing costs due to lower energy consumption .
- Compatible with different types of pallets .

STORAGE THROUGH SHUTTLES

The loading units are stored in the depth. They can be handled through stacker cranes or also with elevators and transport shuttle.

PRODUCTIVITY AND COST REDUCTION

- The automation of the storage systems increases the productivity of your logistic activities.
- A reduction of operating costs and damages, as well as an increase in safety can be achieved through higher levels of automation.



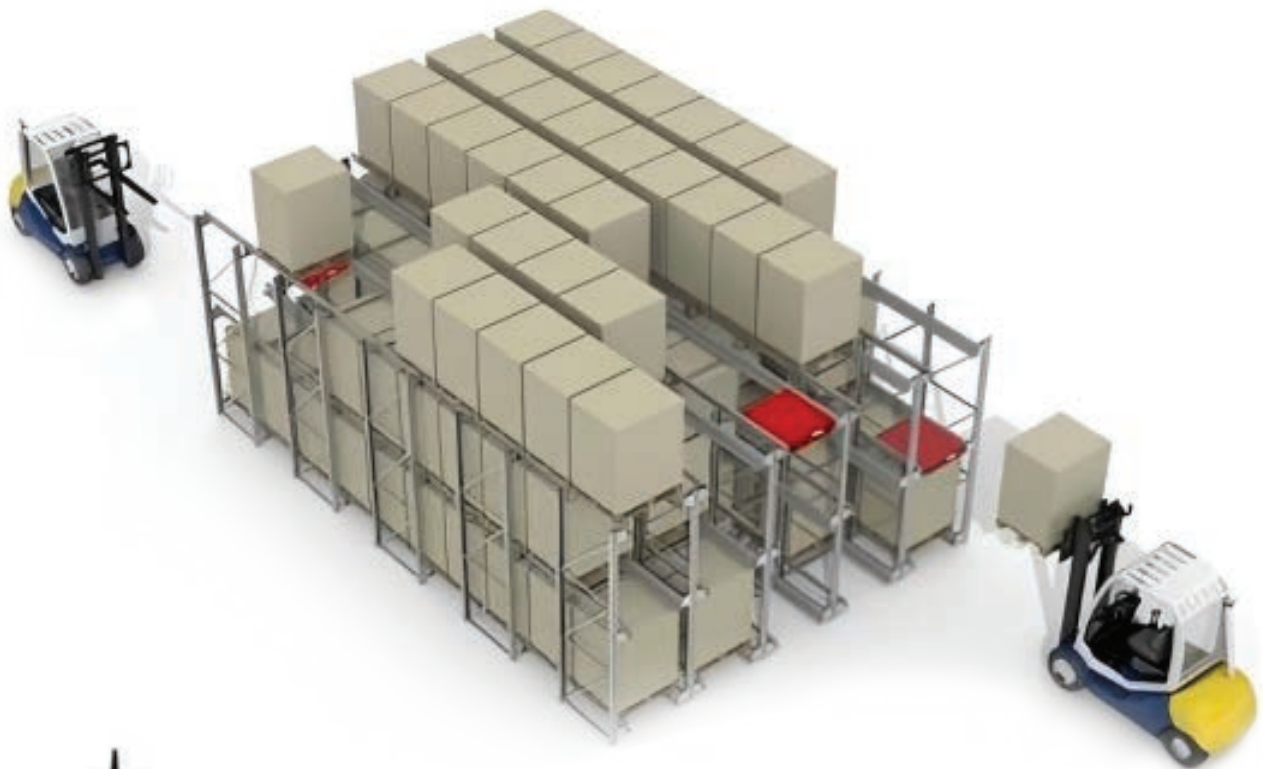

Rechargeable
Remote Controller



Charger



Rechargeable Battery



Radio Shuttle advantages:

- Lower risk of damage to the rack and operator.
- Automatically load, unload, organize pallets with high precision, fast and sustainable.
- Save labor cost, improve work efficiency and inventory turnover.
- Available for different sizes of pallet .

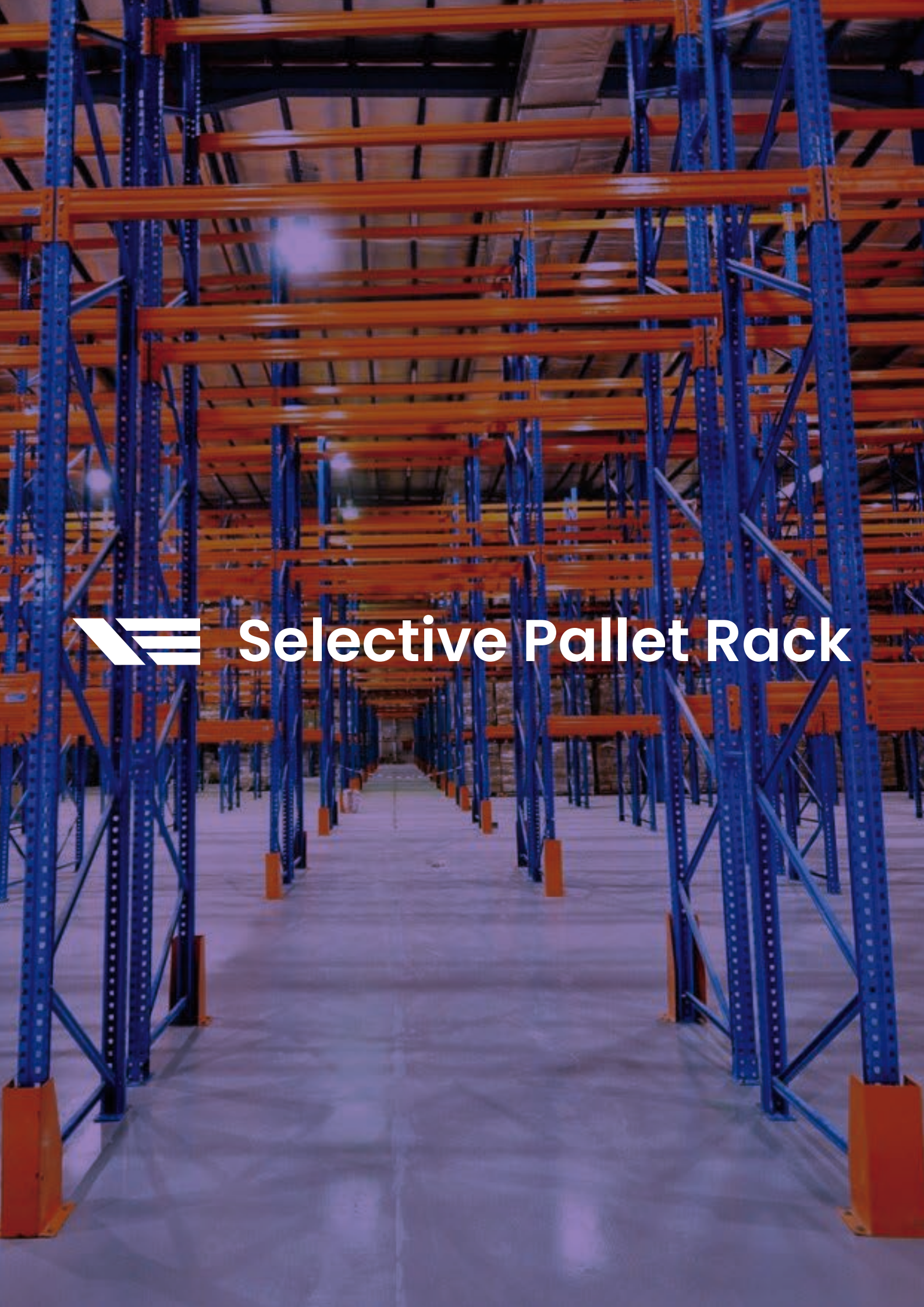

Selective Pallet Rack

➤ Selective Pallet Rack

Industrial shelving system suitable for palletized goods of multiple references.

Characterized by being selective, it allows immediate access to all the loading units with no need to move or displace the other pallets, which favors the warehouse stock controls.

It is adaptable to the type of load to store, as they can be different sizes, Containers, drums, pallets, it can be combined with shelves for picking, manual storage, pallet-drawers.

It keeps the loads perfectly organized.



This is the storage option most universal and versatile that exists on the market, thanks to a wide range of products and accessories that facilitate the storage of all kinds of goods

Furthermore, it's compatible with different models of lift systems

(electric counter- balanced forklift, reach truck, stacker, bilateral tower, trilateral tower and trans-elevator).

Pallet racking system adapts to any storage need, and can have, for instance, double depth in the installation or allowing steps through thereof, etc...The shelving with double depth allows us to keep a larger number of pallets thanks to the elimination of the center aisle.

This option is recommended for products with various pallets by reference, as it's only possible to access directly to the first placed pallets.



Frames :

Vertical structures forming the backbone of a selective pallet rack, these frames consist of upright columns and horizontal braces. They provide stability and support for the entire rack, allowing for the efficient storage of palletized goods with accessibility from both sides.

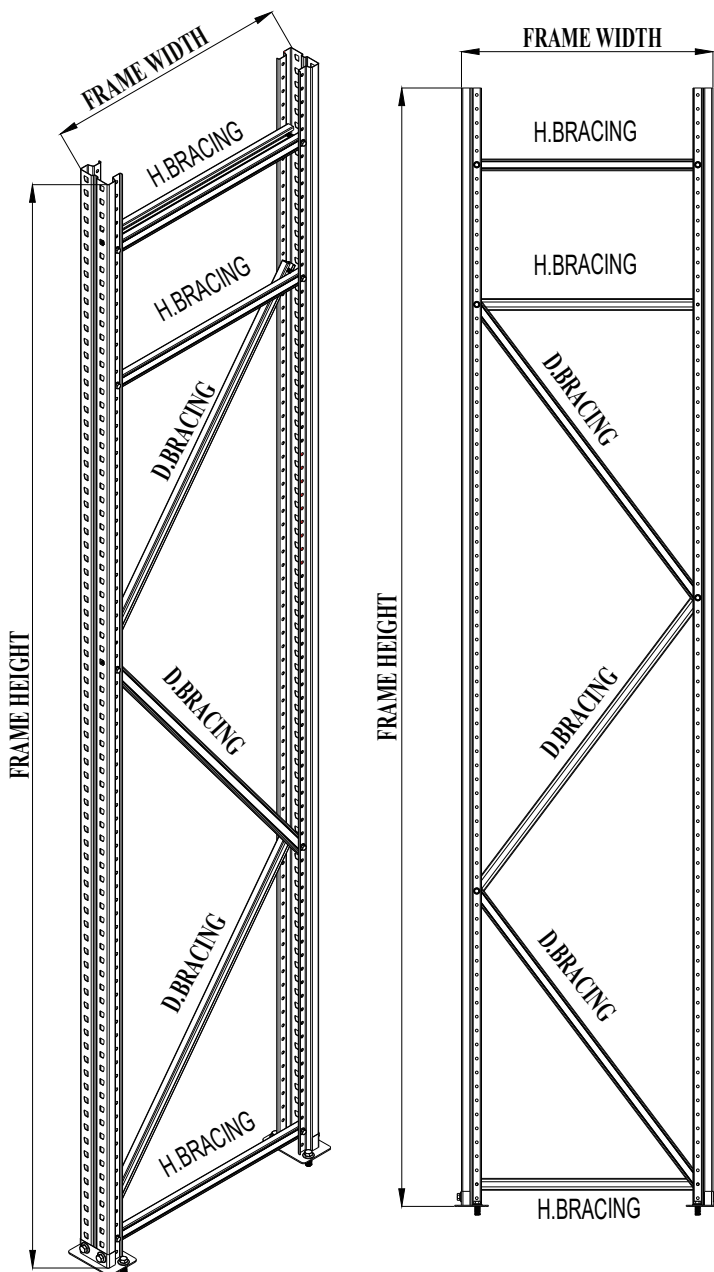

Being modular, the installation is quick and easy, as well as the replacement of parts and every types of expansions. You will be always in time to make changes in the installation according to your needs, allowing at all times the most suitable distribution.

The structure of a Pallet Racking shelving consists of the following elements:

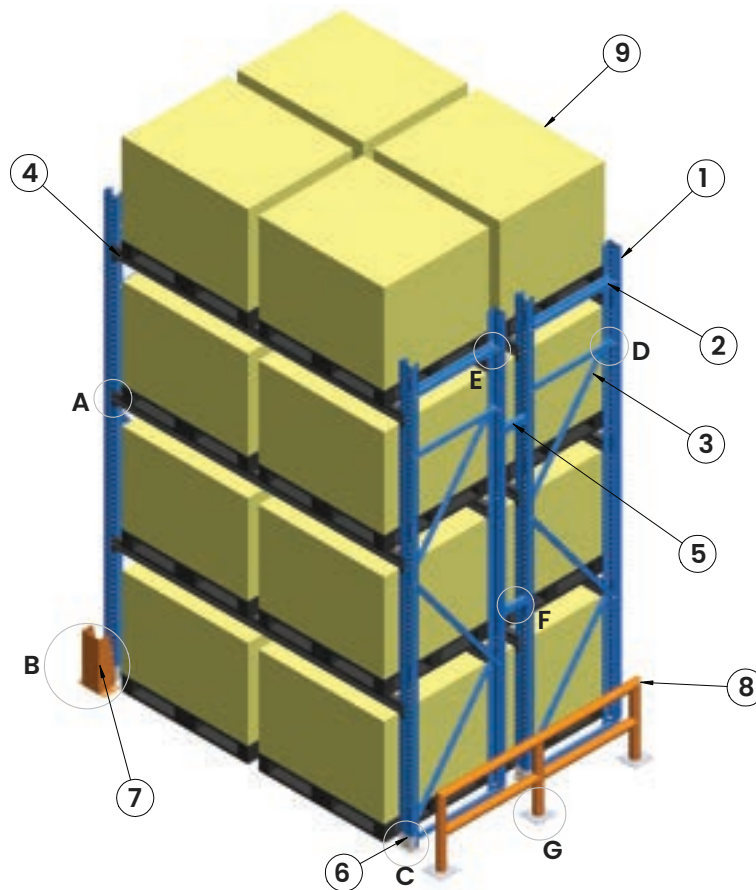

- 1- upright
- 2- Horizontal Bracing
- 3- Diagonal Bracing
- 4- Beam
- 5- Row Spacer
- 6- Base Plate
- 7- Upright Protector
- 8- Frame Protector
- 9- Pallet



Detaile A
Scale 1 : 5



Detaile B
Scale 1 : 10

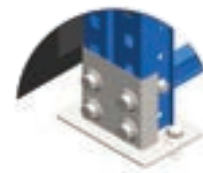

Detaile C
Scale 1 : 5



Detaile D
Scale 1 : 10



Detaile E
Scale 1 : 5



Detaile F
Scale 1 : 10

Type of Uprights:

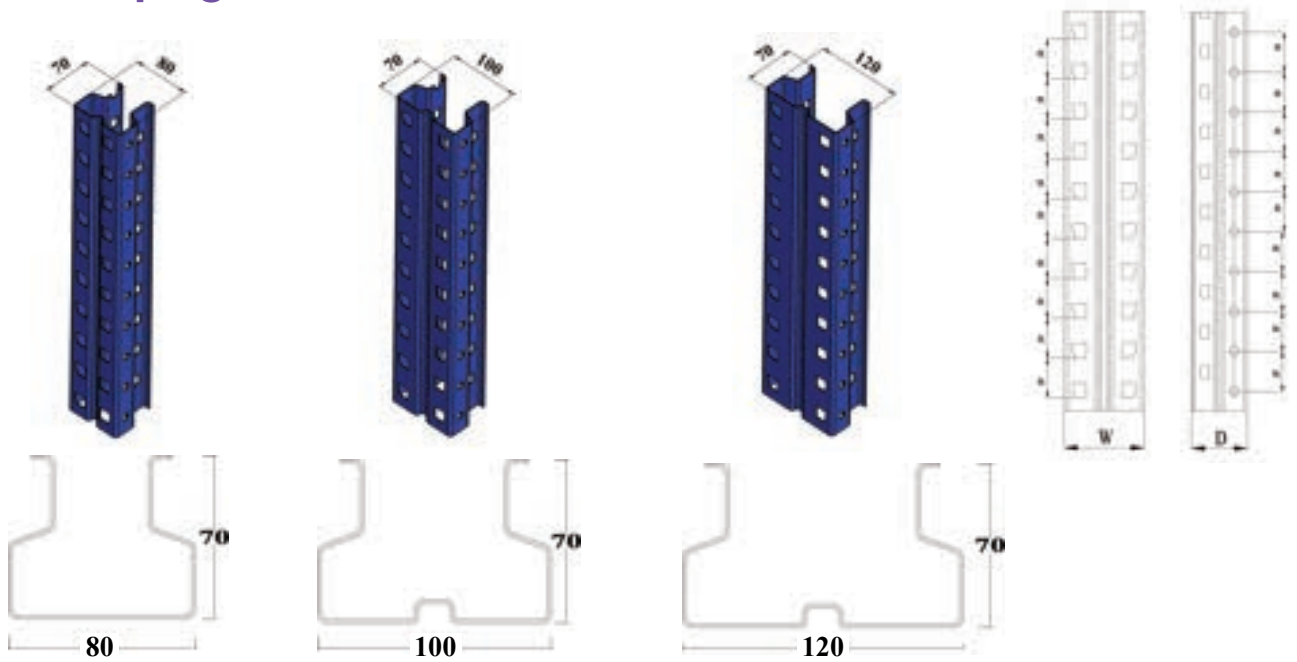

Description	Width	Depth	Thickness
Omega 80*70	80	70	1.5 / 2 / 2.5
Omega 100*70	100	70	1.5 / 2 / 2.5
Omega 120*70	120	70	1.5 / 2 / 2.5

Type of Box Beams:

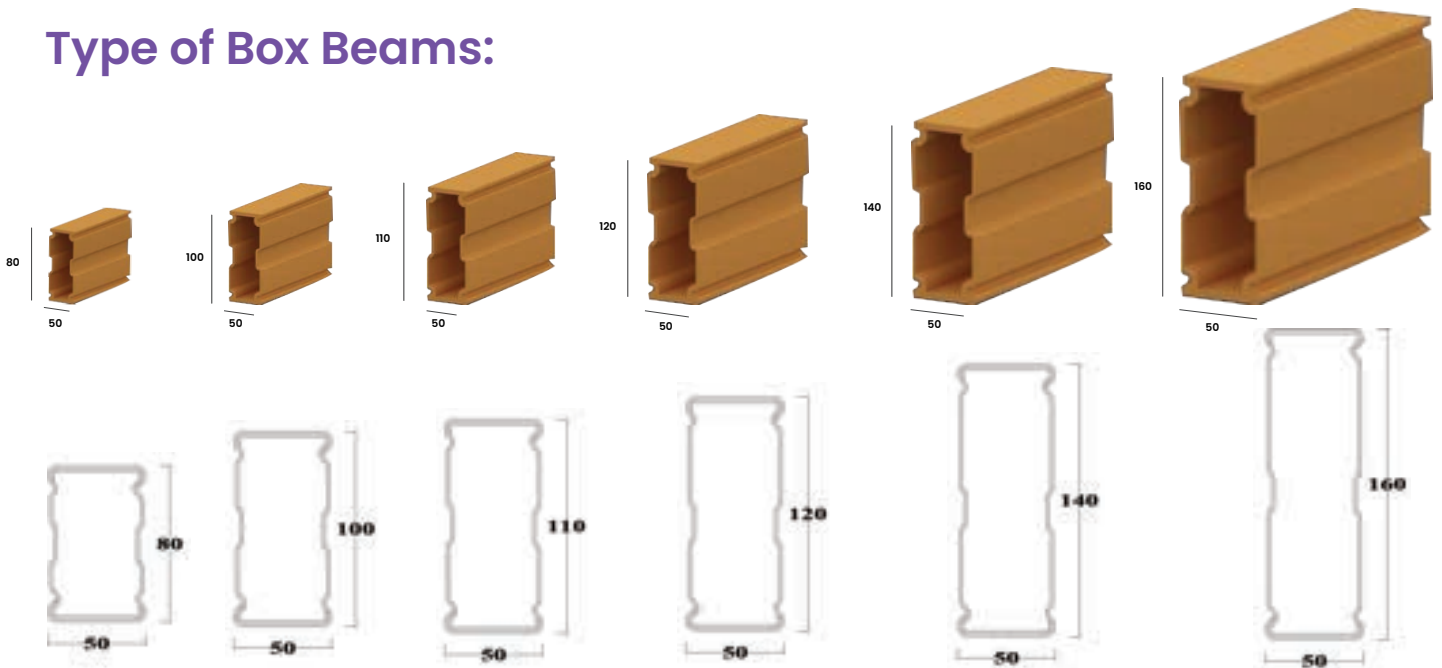

Description	Width	Depth	Thickness
Box 80*50	80	50	1.5/1.8/2
Box 100*50	100	50	1.5/1.8/2
Box 110*50	110	50	1.5/1.8/2
Box 120*50	120	50	1.5/1.8/2
Box 140*50	140	50	1.5/1.8/2
Box 160*50	160	50	1.5/1.8/2



Drive-In Racking



➤ Drive-In Racking

IT IS THE IDEAL SYSTEM TO STORE LOADS WITH THE SAME REFERENCE IN DEPTH

- Greater storage density.
- Up to 85% of the available space can be used.
- It can be adapted to different space requirements as well as to goods' measures, weights and volumes.

It consists of series of lanes by which fork-lifts enter so as to place the pallets on the rails. Those rails can be located at different heights, depending on customer's storage necessities



This storage system is characterized by its high density, something that boosts productivity by the optimization of the available resources

RX Matrix offers two types of compact systems:

Drive in: Its configuration only counts with one loading entry.

Drive Through: It counts with one entry by each end.

Both options support heavy loads, offering each one of them great resistance and safety







Each lane has floor guide rails that facilitates the entrance and the exit of forklifts, avoiding collisions or accidental impacts that could damage the installation

This kind of storage system is appropriate for non-perishable goods, as well as for storing loads at low temperatures

SYSTEM COMPONENTS

The structure of a Drive-In storage system includes the following elements:

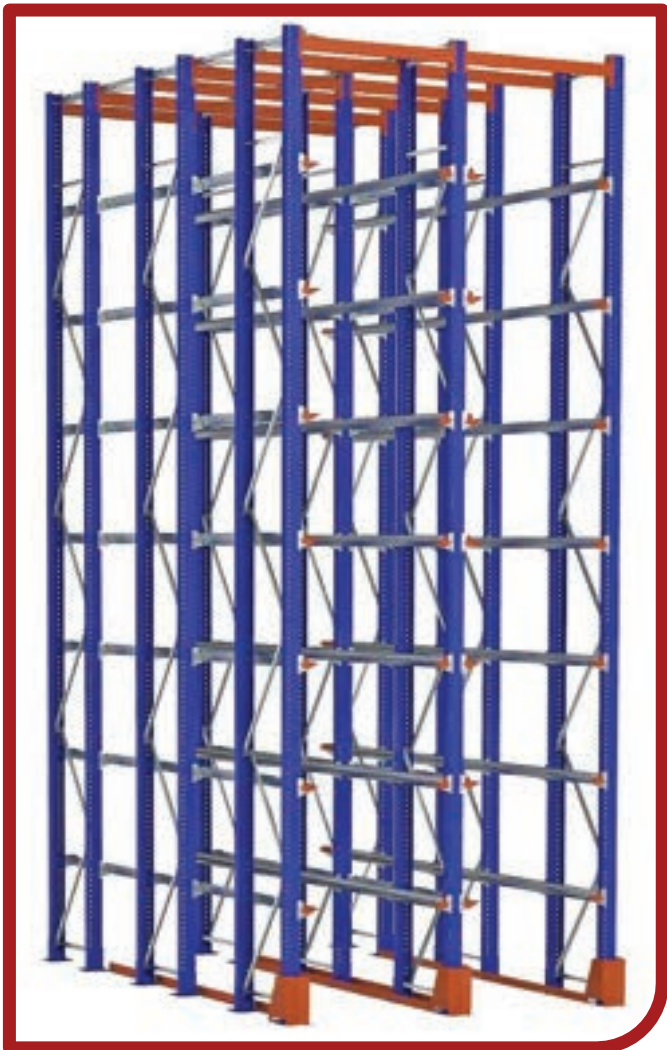

DETAIL OF BRACING CONNECTION



BASE PLATE



UPRIGHT

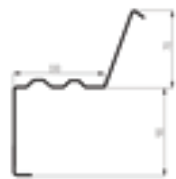

PALLET RAIL

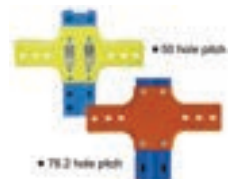

STAMPED BRACKET
Left / Right



FLOOR GUIDE RAILS

They are a forklift guidance system that allows:

- Achieve high productivity levels.
- Reduce potential damage to shelves, products, or equipment.
- Increase safety and operator efficiency, concentrating their attention on the cargo handling.
- Work in lanes with more than six meters' depth and height

Wall

DRIVE IN - ENTRANCE AT ONE END OF THE INSTALLATION

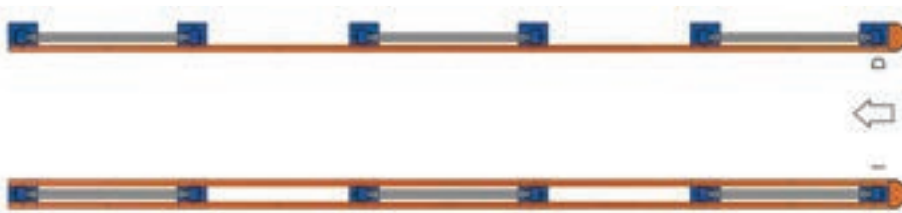

DRIVE THROUGH - ENTRANCE AT BOTH ENDS OF THE INSTALLATION

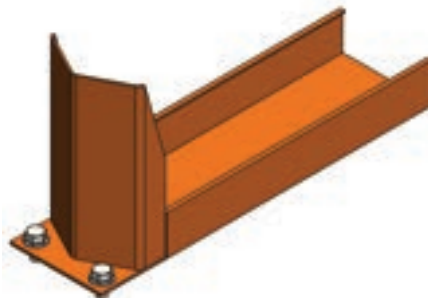



RIGIDITY TOWER

It is a cross bracing layout located along an entire aisle over its entire length. Same as vertical bracing serves to increase the rigidity and stability of the installation.

Top horizontal bracing will always be placed on the upper horizontal rigidity aisle.

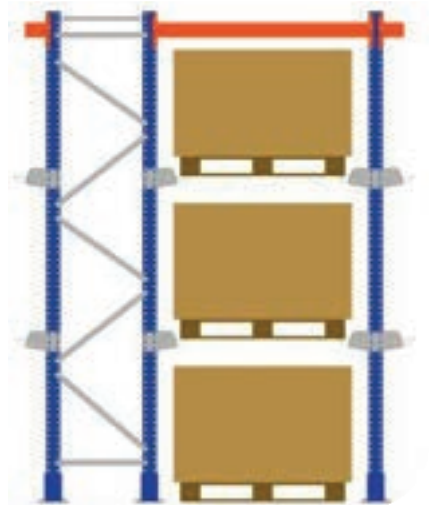

Rigidity Tower



Top Horizontal Bracing

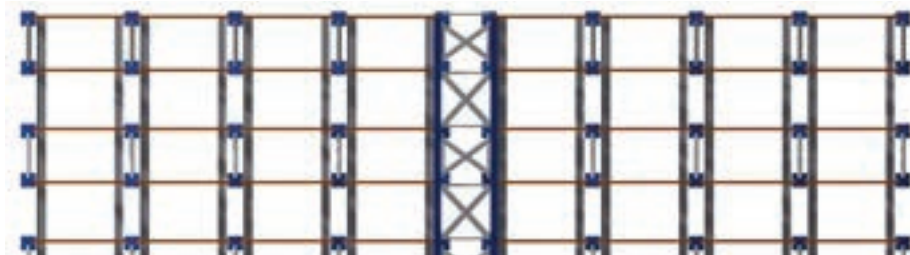



Mobile Pallet Racking

➤ Mobile Pallet Racking

A storage system with mobile bases is composed of single or double entry runs placed on a mobile metallic structure, which allows the movement of the shelves independently

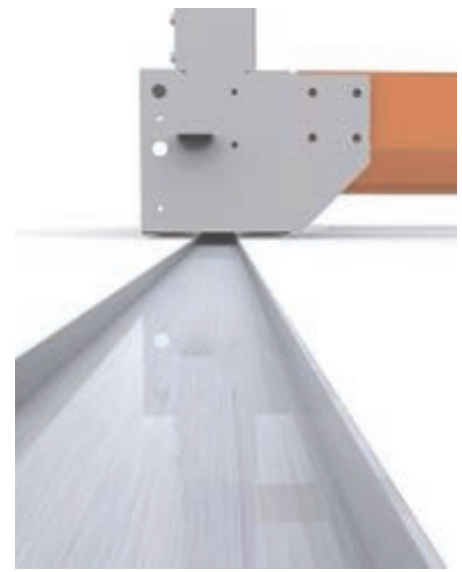

SYSTEM COMPONENTS :

1.SHELVES

This storage system is the metallic structure mounted on the mobile bases, and they are usually standard pallet racking, which is usually used to sustain heavy loads.

2.MOBILE BASES

It is the metallic structure supported on wheels where the shelves are mounted, and they allow the movement of those racks

3.RAILS

Those are the steel profiles inserted in the floor whereby the wheels of the mobile bases move through



MAIN FEATURES:

When the reduction of the space is the main criterion or necessity when developing the required storage solution, this option with mobile bases is the most adequate.

A pallet rack with mobile bases is the ideal system for cold stores (for both refrigerated and frozen goods) where the cost of storage (frozen cubic meter) is too high, since this system allows the maximum use of the space possible.

This system with mobile bases increases the storage capacity and reduces the free space in the warehouse by eliminating the aisles except one and by allowing the direct access to each pallet.

It is very simple in terms of its use, since the shelves are installed on the mobile bases, which allows the movement of each run laterally through the rails fixed to the floor, thus avoiding the existence of unnecessary aisles, but always having direct access to each pallet or store goods

The aisle which needs to be accessed is selected manually or by remote controller.

This system allows the storing of a huge number of different references, and it is compatible with other storage systems such as picking in bottom levels. It also guarantees the safety of people working there and the preservation of the goods in good.

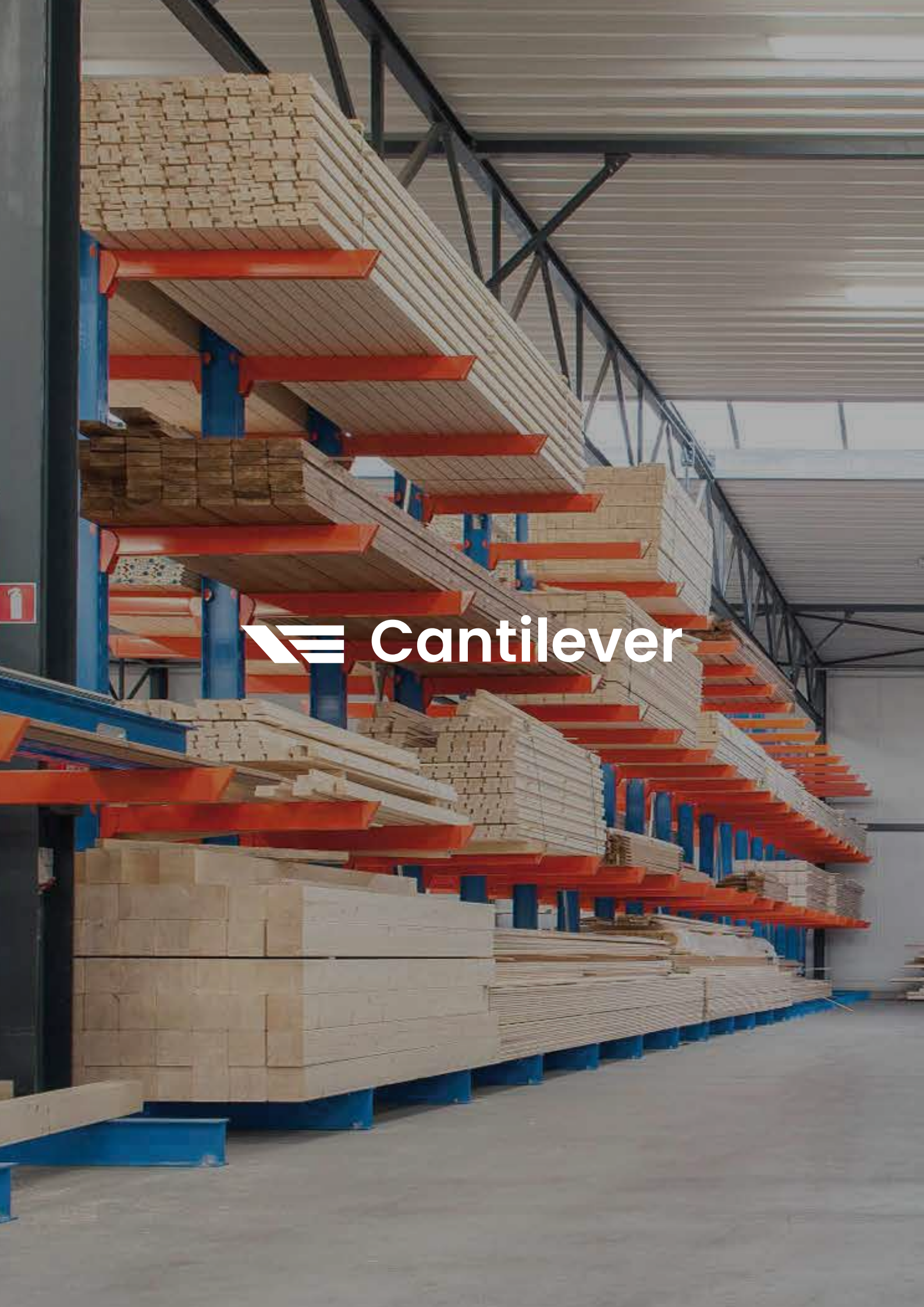

 **Cantilever**

➤ Cantilever

It is a storage system designed for loads which have great volumes or lengths. This type of system is perfect for storing wood strips, boards, tubes of different materials, profiles, etc.

It can have multiple configurations, depending on the storage necessities, which gives a great warehouse management flexibility:

- The arrangement of loads could be horizontal or vertical.
- It can have simple or double structure.
- It can be used for heavy or light loads.

SYSTEM COMPONENTS

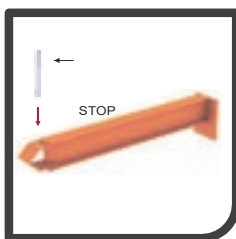
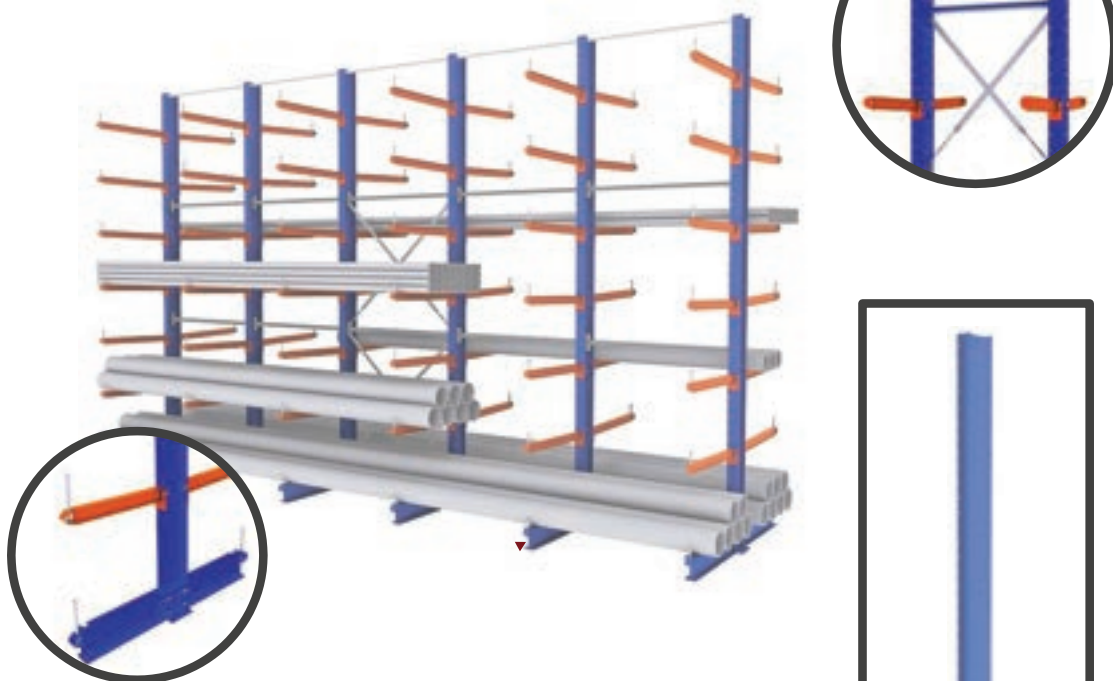

IPN ARM

Standard finishing
Orange 2004



IPE BASE

Standard finishing
Blue 5019



BRACING SYSTEM

Standard finishing
Pregalvanized

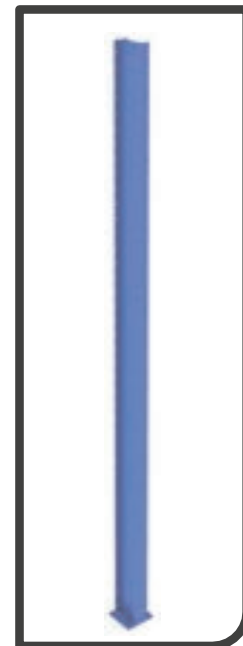

COLUMN
(SIMPLE OR DOUBLE)

Standard finishing
Blue 5019



CANTILEVER RACKING

Designed for the storage of long, awkward, or irregularly shaped items such as lumber, pipes, and tubing.

Adjustable Arms:

Arms are adjustable in height and can be modified to accommodate varying load sizes.

Easy Accessibility:

Open-front structure allows for easy access and retrieval of stored items, facilitating efficient inventory management.

Heavy-Duty Construction:

Built with robust materials to handle heavy loads and ensure durability over an extended lifespan.

Standard Dimensions

Column height CAB medium loads (H*)	2500	3000	3500	4000	4500		
Column height CA Large loads (H*)	4000	4500	5000	5500	6000	6500	7000
Arm Length (L*)	600	800	1000	1250	1500		
Dimensions in mm							

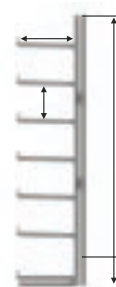

Simple



Double



Mobile Shelving



➤ Mobile Shelving

Mobile shelving offers a space-saving solution that can yield up to a 50% reduction in space requirements by eliminating the need for aisles between rows of shelves. Alternatively, it maximizes the utilization of the available floor space, almost doubling your storage or archiving capacity.

our mobile shelving system, is highly adaptable to various environments. It is available in three versions: mechanical movement using hand wheels with gearing down, electromechanical movement, and a manual push version. Moreover, our shelving units can be customized with external panels to protect against dust or can be left open, depending on your specific needs.

A storage solution with movable shelves, optimizing space and accessibility by eliminating fixed aisles. Ideal for high-density storage in various environments.

Features of Mobile Shelving System:

- Space Optimization
- High Density Storage
- Customizable Design
- Smooth Mobility
- Security and Access Control
- Modular Construction
- Efficient Retrieval







Mezzanine

» Mezzanine

STORAGE SYSTEM FOR MANUAL LOADING IN HEIGHT

It is a storage system made of frames connected by horizontal shelves or beams with decks to provide unit load storage levels which can be adjusted vertically, with two or more personnel accessible floor levels (tiers). The access to those different levels is carried out by several staircases placed at different points according to client's necessities and security requirements.

In some occasions, the upper part of this installation is used for storing greater loads in volume and as a working area.

This system can be made of pallet racking, long span racking, or boltless Riveto, depending on the load, the installation area or client's necessities. There are two different finishes: painted or galvanized. The loading levels can be made of wood or metallic deck, the same as the walkaways.

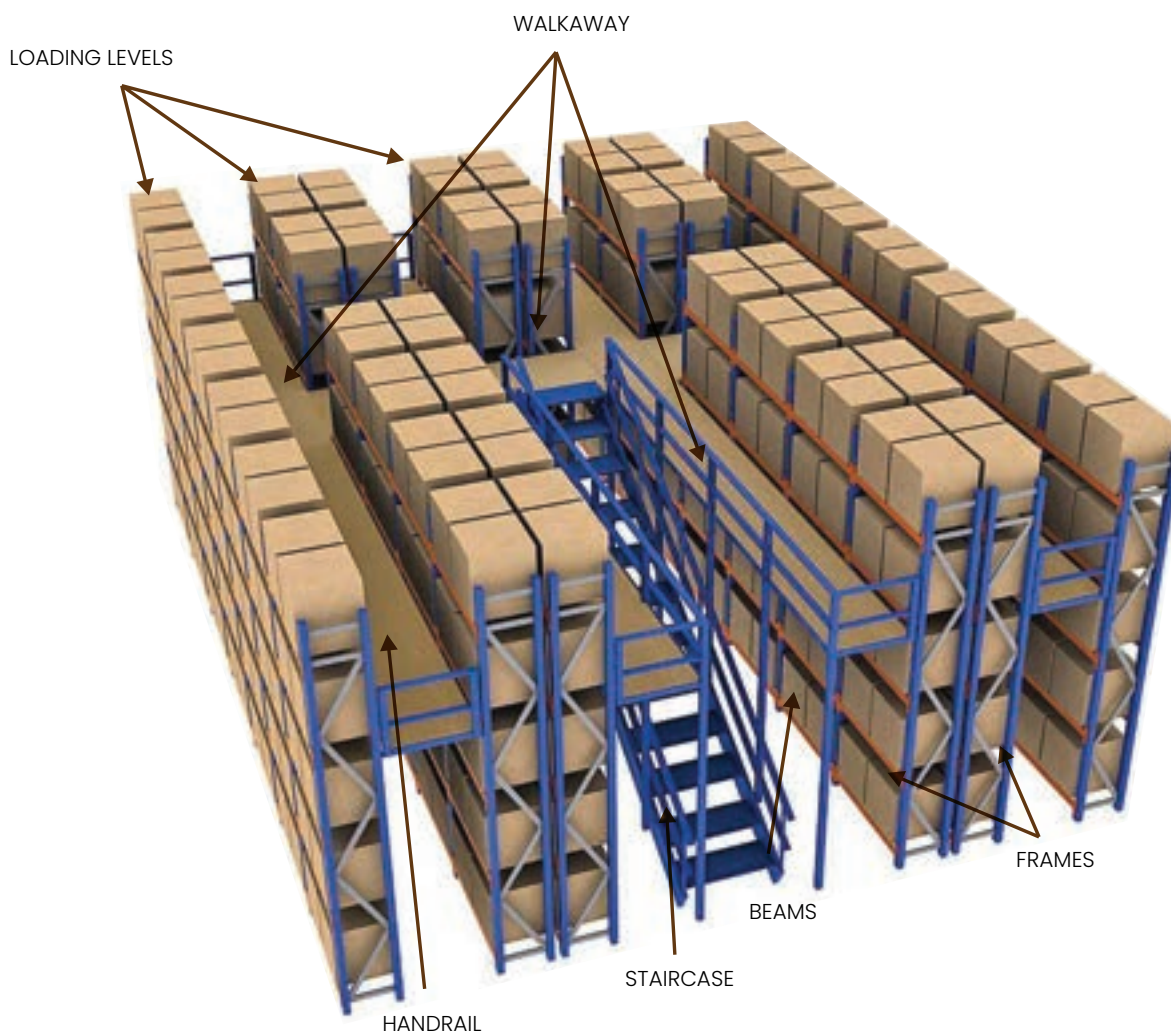

COMPONENTS

FRAMES

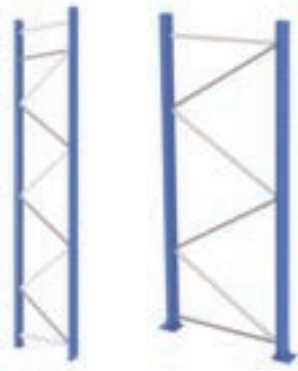

Long span frames

Pallet racking frames

BEAMS



Long span beams

Pallet racking LNS beams

LOADING LEVELS

The loading levels can be decked with:

- Metallic panel or shelf.
- Chipboard.
- Electrowelded mesh



WALKAWAYS

The walkways can be made of:

- Steel deck
- Wood
- Grating



HANDRAILS

Safety handrail



STAIRCASE

Our standard solution is made of tubes with different dimensions fitted and bolted.



- Frontal access by the center of the installation



- Lateral access



- Frontal access between two shelves



- Lateral access with an order preparation area



- Mezzanine floor on the top

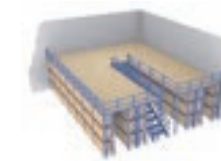

- Multi-tier system with Boltless



MEZZANINE ACCESSORIES

DOORS

In order to place the load in the picking area or in the mezzanine floor, it is necessary to have access to unload the goods with the help of a forklift.



SWING DOOR



SLIDING DOORS



SWIVELLING DOOR

FRAME BARRIERS

In a multi-tier system, it is advisable to use full frame protections at floor level to avoid damages produced by the handling equipment.

They are formed by UPN profiles which are fixed through intermediate feet:



FALL MESH PROTECTOR

Due to the risk of falling objects, from the walkways as well as from the mezzanine floors of the upper areas, it is advisable to use fall mesh protectors





Long Span Shelves

» long Span



It is fast and very easy to assemble and use. a modular design with a bolt free lock-in system which require no special tools giving you maximum storage in minutes whatever your available space.

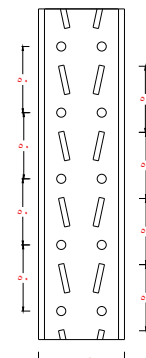

Front View

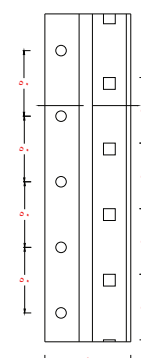

Side view

Long Span Upright

Description	Width	Depth	Thickness
Omega 55*45	55	45	1.5 / 2
Omega 65*70	65	70	1.5 / 2

➤ Slotted Angle

The Slotted Angle system is a versatile solution designed to cater to diverse storage needs across various industries, including workshops, warehouses, and retail spaces. This steel shelving system is exceptionally adaptable, accommodating both long-term storage requirements and urgent demands that necessitate quick solutions. It boasts a wide range of load-bearing capacities, suitable for both light and heavy-duty applications.



One of its standout features is the ease with which Slotted Angle shelving can be expanded

horizontally and vertically, making it a highly flexible choice. Installation is a breeze and doesn't require any specialized tools, making it ideal for manual warehousing setups. For businesses with evolving needs, the system can be further extended by incorporating decking or gangways, accessible via pre-assembled staircases. This adaptability ensures that the Slotted Angle system can grow in tandem with your business.





Locker Key
Locker Key No.
1-1



Lockers



4

FD
Close The Door

4

FD
Close The Door

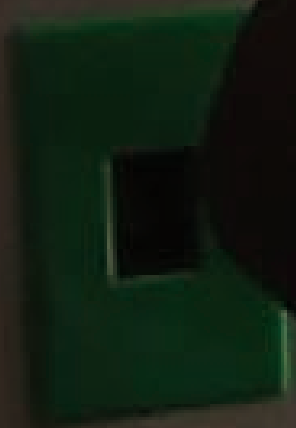
FD

FD

➤ Lockers



A worker locker, also known as an employee locker, is a storage unit or compartment typically provided by employers in workplaces, factories, offices, or other settings. These lockers are used by employees to securely store their personal belongings, such as clothing, bags, and personal items, while they are at work. Worker lockers are essential for maintaining a clean and organized work environment, as they help prevent clutter and ensure that employees' personal items are safe and secure during their working hours.





Mobile Yard Ramp

➤ Mobile Yard Ramp

Handling the rapid loading and unloading of lorries and containers is an everyday necessity in the modern logistics industry. For years, RX matrix Mobile yard ramps have been the reliable solution for performing this task efficiently and securely under tight time constraints





Dock leveler

➤ Docklevler



Docklevler come in various types, including hydraulic, mechanical, and air-powered systems. They are adjustable in height to accommodate different vehicle bed heights and can support various load capacities. Docklevler enhance operational efficiency, improve safety, and help prevent damage to goods and equipment during the loading and unloading process. They are a critical component of many loading docks.

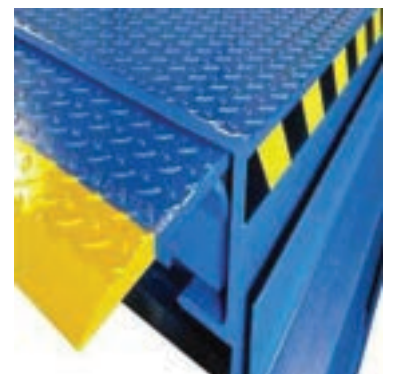



Forklifts

» Forklifts

Forklifts are indispensable tools in warehouse operations, serving a crucial role in material handling and logistics. With their ability to lift, move, and transport heavy loads, forklifts contribute to the efficiency and productivity of warehouse activities. These versatile machines are designed to navigate through narrow aisles, making them essential for the quick and precise placement of goods on shelves and racks. Their adaptability to various environments and load capacities makes forklifts a cornerstone in modern warehouse management.

Three-Wheeler



Four wheel forklift



Reach Truck



Power Pallet



Articulated



Cabin up



➤ Hand Pallets



A hand pallet, often referred to as a manual pallet jack or hand pallet truck, is a simple yet essential material handling tool used in warehouses, factories, and various industrial settings. It is designed to move palletized loads within a facility. Hand pallets are manually operated, meaning they don't require a power source to function.

Model		RX-P20	RX-P25	RX-P30
Capacity	(kg)	2200	2500	3000
Lifting height	(mm)	115		
Max.Fork height	h (mm)	200 (or 190)		
Min.Fork Height	h2 (mm)	85 (or 75)		
Fork length	l (mm)	1150 / 1220	1150 / 1220	1150/1220
Fork width	b (mm)	160	160	160
Width overall forks	B (mm)	540/685	540/685	540/685
Load roller	(mm)	Tandem 82x70, single 82x93 Nylon, Polyurethane		
Steeling wheel	(mm)	200x50 Nylon, Polyurethane or Rubber		
Net weight	(kg)	80/83	82/85	85/87





Goods Elevator

➤ Goods Elevator

A goods elevator, also known as a freight or cargo elevator, is a specialized vertical transportation device designed for efficiently moving goods and materials between different floors of a building or warehouse. Unlike passenger elevators, these elevators are constructed to handle heavier loads and are equipped with robust features to ensure the safe and secure transportation of goods. They play a vital role in streamlining logistics, enhancing warehouse efficiency, and facilitating the movement of bulky or heavy items within industrial and commercial settings.





Pallets

➤ Pallets

Pallets are indispensable logistical tools, adding value by providing a standardized and efficient means for transporting, storing, and handling goods. Their design facilitates easy loading and unloading using forklifts or pallet jacks, contributing to streamlined supply chain operations and reduced product damage risk.

Steel Pallet:

A heavy-duty pallet constructed from steel, offering exceptional strength and durability. Steel pallets are suitable for demanding industrial environments and provide a long-lasting solution for material handling.

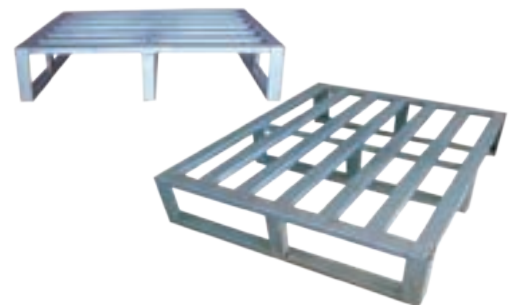
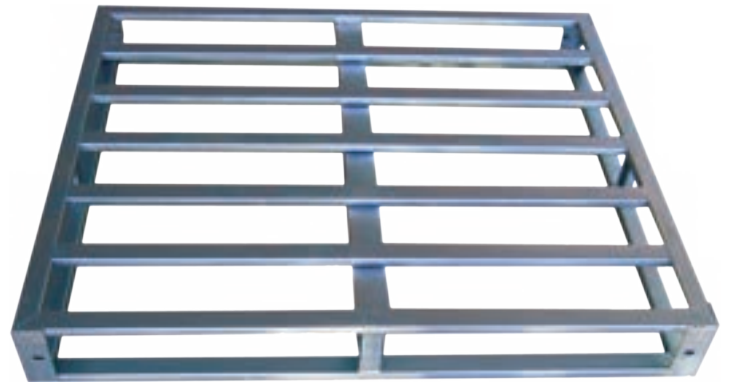

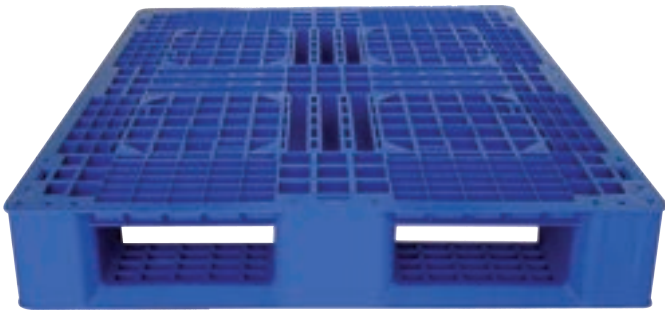

Plastic Pallet:

A durable and lightweight logistics platform made from plastic, offering resistance to moisture, chemicals, and pests. Ideal for various industries due to its longevity and recyclability.

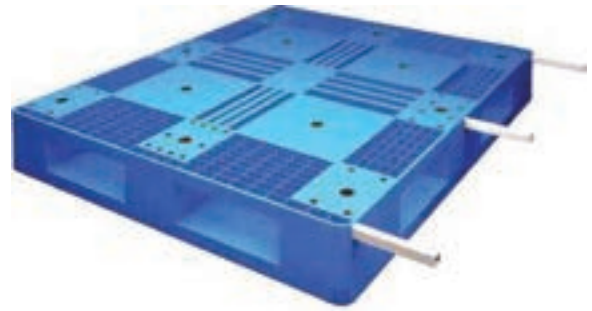
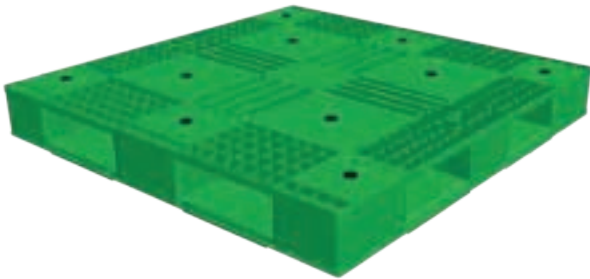

Wooden Pallet:

A classic and widely used pallet crafted from wood, known for its strength, cost-effectiveness, and suitability for one-way shipments. It provides robust support for goods during transportation and storage.



➤ Cages

Metal cages are durable and versatile containment structures crafted from sturdy materials such as steel or aluminum. Designed for various applications, these cages provide a secure and robust solution for storage, transport, or confinement needs.



MAIN FEATURES:

Metal cages are built to last, with sturdy materials that resist wear and tear.

The robust construction of metal cages provides a high level of security for stored items or animals.

Available in various sizes and designs, metal cages are adaptable for different purposes, from industrial storage to transportation.



➤ Racks Accessoires

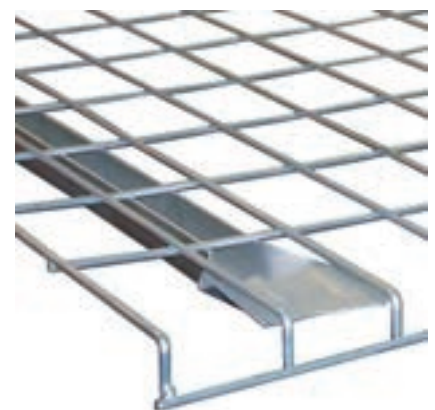
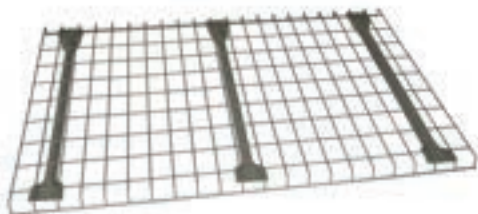





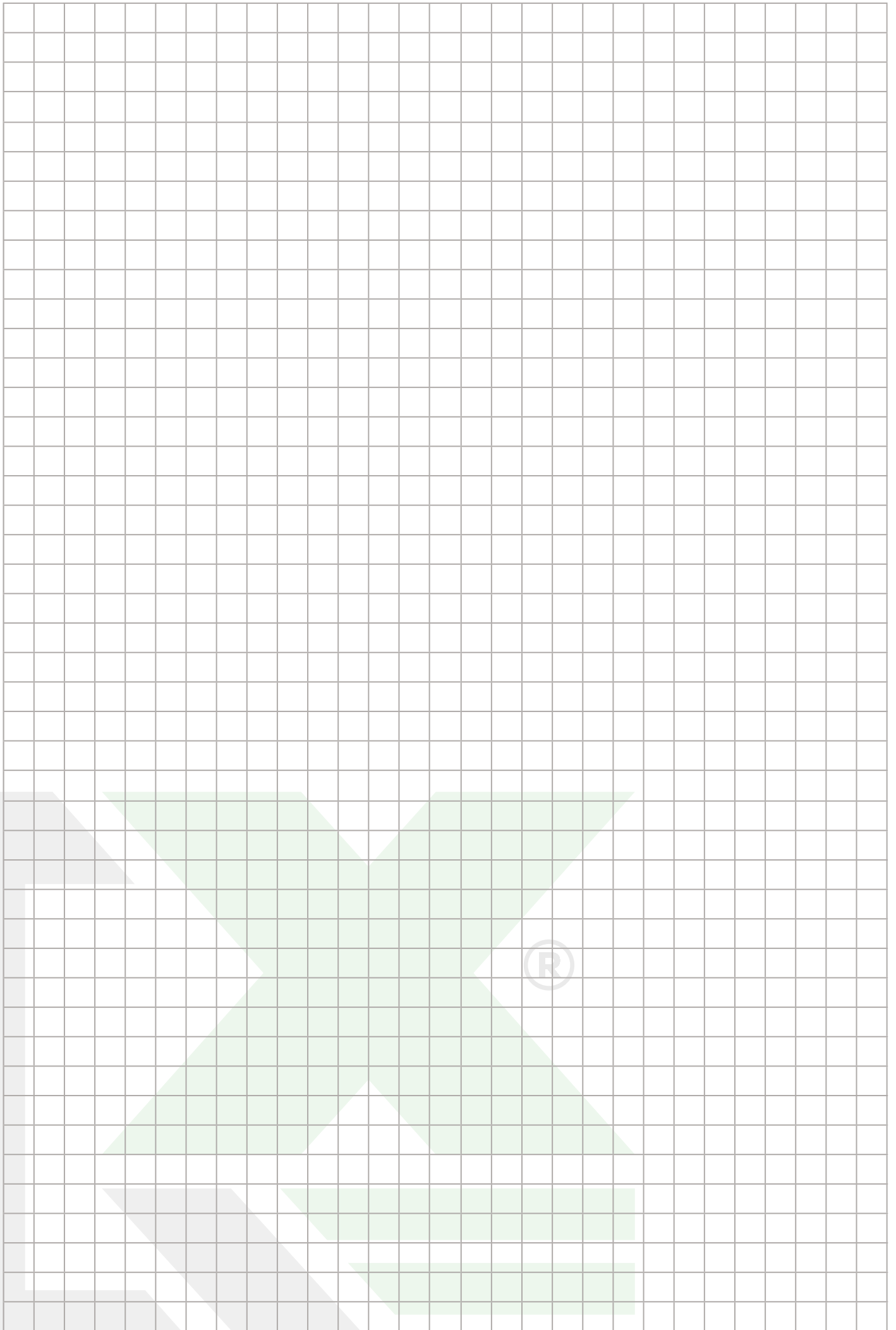

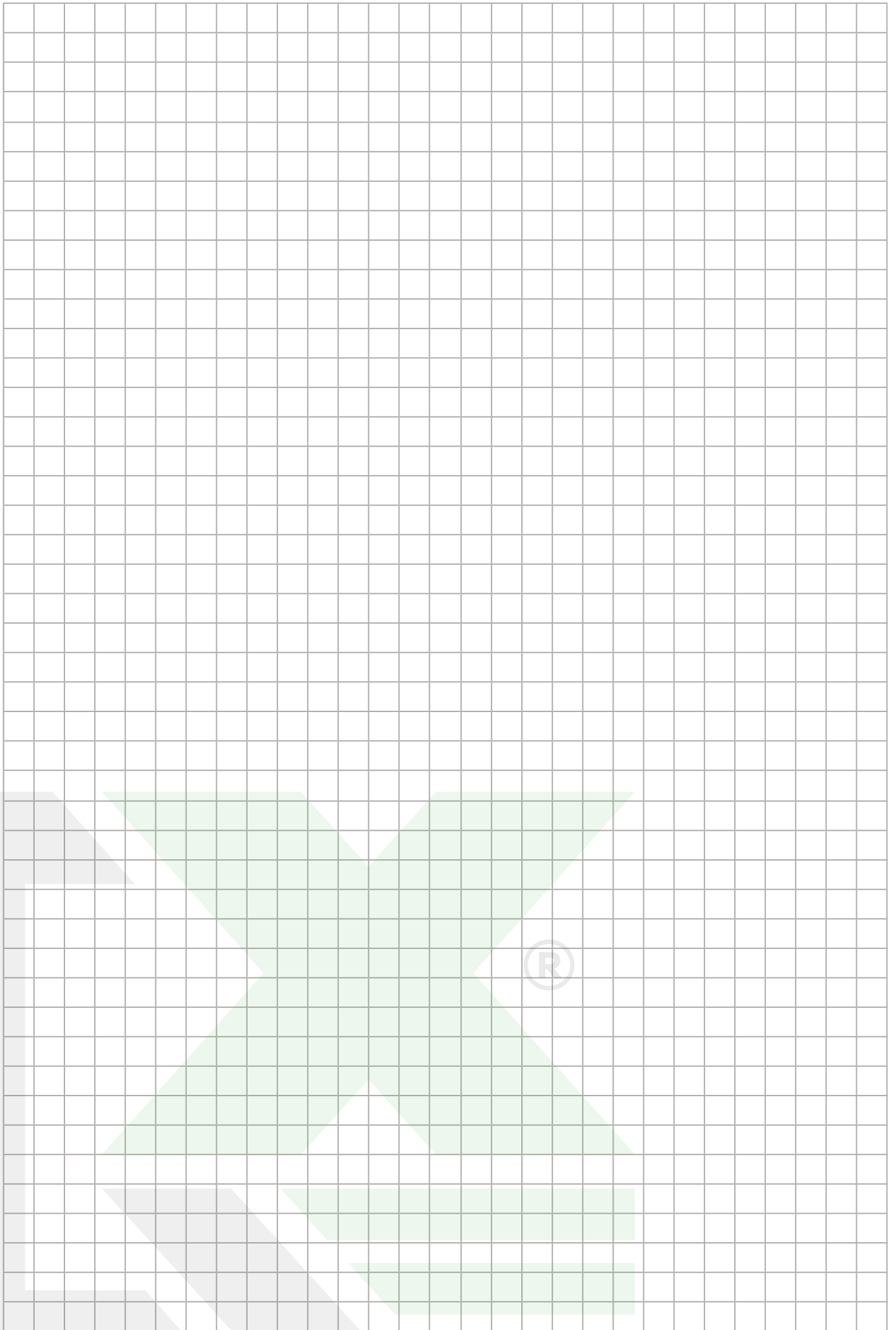

GET IN TOUCH NOW



00966538488001
00966557667476
00966502443373



info@racksmatrix.co



www.racksmatrix.com

Factory:

Al-Sulay – Istanbul Street – Riyadh – KSA



Head Office:

Rabwah District – Riyadh – KSA